



Ash River Access Road  
Erosion Control Project  
2012

### The Problem:

The problem at this site is an eroding driveway and access road leading to area properties. The soils are sandy to gravelly with steep slopes. The access road is steep and allows runoff water from the impervious surfaces to run down the middle of the road, which is the lowest point. The slope length is approximately 500 lineal ft which collects water of which the Shega driveway is approximately 150 lineal feet long of the total. The driveway and access road has a convex shape which allows for the water to run down the middle and erode the middle of the driveway making it nearly impassible by cars. My recommendation below addresses the entire 500 lineal feet of access road which includes the Shega driveway. If just the Shega driveway it still leaves a length of roadway that would be in poor condition with resulting runoff into Ash River.





Original Plans:

Results Pictures:





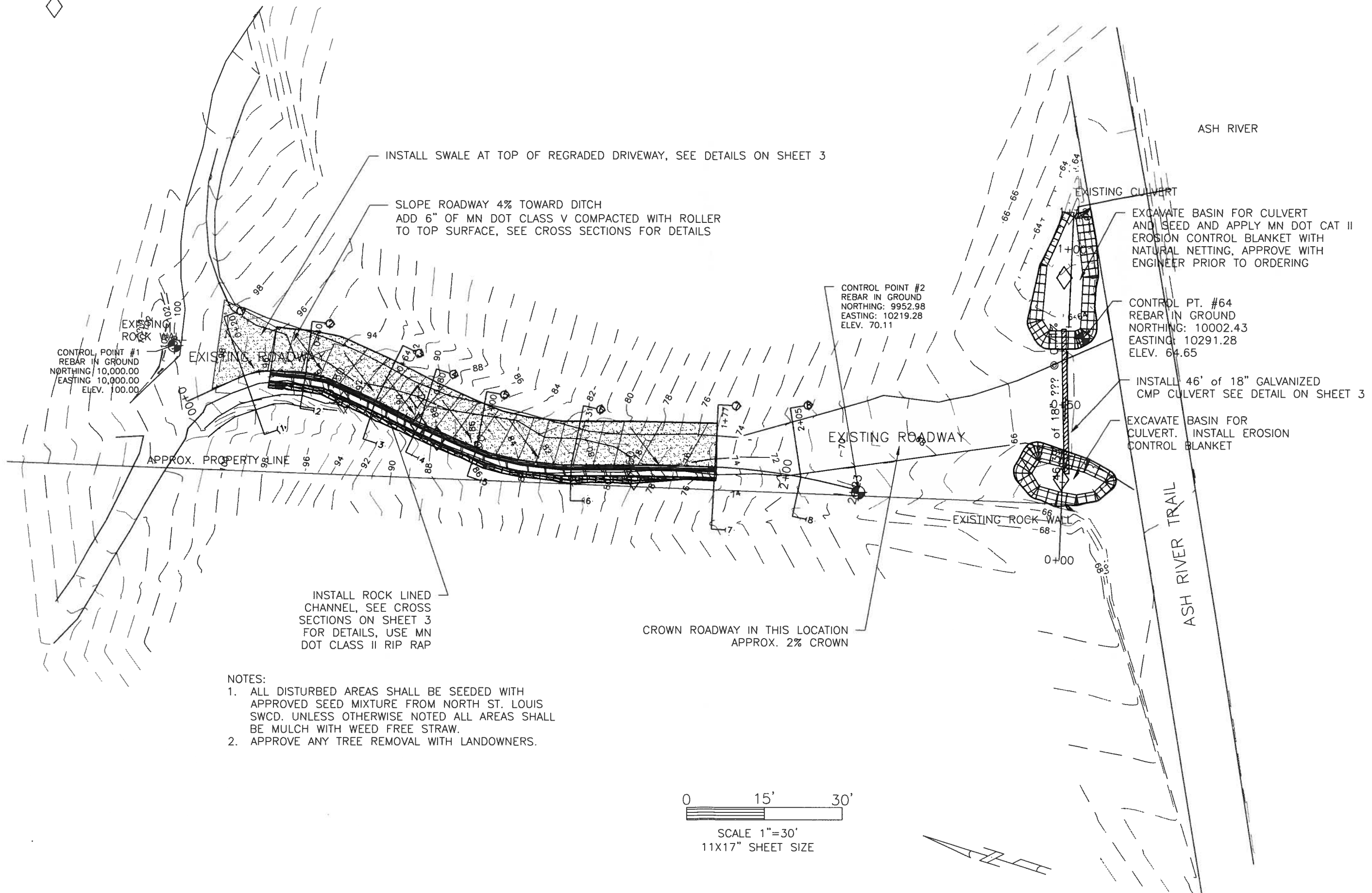

- NOTES:
1. ALL DISTURBED AREAS SHALL BE SEEDED WITH APPROVED SEED MIXTURE FROM NORTH ST. LOUIS SWCD. UNLESS OTHERWISE NOTED ALL AREAS SHALL BE MULCH WITH WEED FREE STRAW.
  2. APPROVE ANY TREE REMOVAL WITH LANDOWNERS.

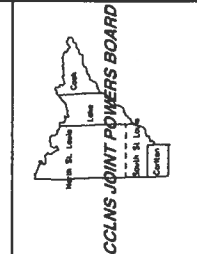
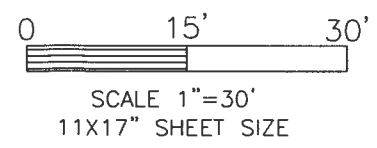

Date	12/10
Designed	KA
Drawn	KA
Revised	
Checked	

PLAN  
SHEGA/ASH RIVER ROADWAY STABILIZATION  
N. ST. LOUIS - SWCD  
ST. LOUIS COUNTY, MINNESOTA

THEREBY CERTIFY THAT THIS PLAN, SPECIFICATION, OR REPORT WAS PREPARED BY ME OR UNDER MY DIRECT SUPERVISION AND THAT I AM A DULY LICENSED PROFESSIONAL ENGINEER UNDER THE LAWS OF THE STATE OF MINNESOTA.

PRINTED NAME: KEITH A. ANDERSON  
SIGNATURE: *[Signature]*  
DATE: 1/28/11

REG. NO. 42827

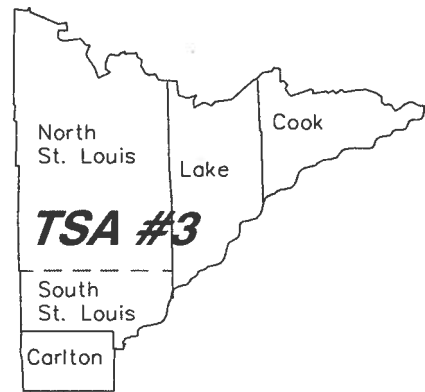

# TSA #3 IN COOPERATION WITH NORTH ST. LOUIS SOIL AND WATER CONSERVATION DISTRICT SHEGA/ASH RIVER ROADWAY STABILIZATION ASH RIVER, MINNESOTA

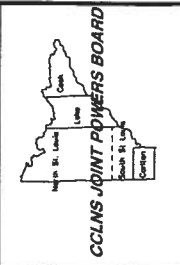

Designed AAA Date 12/10  
 Drawn AAA Date 12/10  
 Revised \_\_\_\_\_  
 Checked \_\_\_\_\_

DRAWING INDEX

SHEET NUMBER	NAME
1.	TITLE
2.	PLAN
3.	CROSS SECTIONS/PROFILE

MN DOT APPLICABLE SPECIFICATIONS

THE FOLLOWING MN DOT STANDARD SPECIFICATIONS FOR CONSTRUCTION, 2005 EDITION, GOVERN THIS PROJECT

DIVISION I

ENTIRE DIVISION

DIVISION II, CONSTRUCTION DETAILS

- SECTION 2105 EXCAVATION AND EMBANKMENT
- SECTION 2501 PIPE CULVERTS
- SECTION 2511 RIP RAP
- SECTION 2573 STORM WATER MANAGEMENT
- SECTION 2575 CONTROLLING EROSION AND ESTABLISHING VEGETATION

DIVISION III, MATERIALS

- SECTION 3226 CORRUGATED STEEL PIPE
- SECTION 3601 RIPRAP MATERIAL
- SECTION 3733 GEOTEXTILES
- SECTION 3876 SEED
- SECTION 3885 EROSION CONTROL BLANKETS

NOTES:

1. EXISTING UTILITIES SHOWN ON THE PLANS ARE UTILITY LEVEL D.
2. BEFORE THE START OF CONSTRUCTION THE OWNERS OF ANY UTILITIES MUST BE NOTIFIED. THE EXCAVATOR IS RESPONSIBLE FOR GIVING THIS NOTICE BY CALLING "GOPHER STATE ONE CALL" AT (800) 252-1166 AT LEAST 48 HOURS PRIOR TO ANY EXCAVATION.
3. CHANGES IN THE DRAWINGS OR SPECIFICATIONS MUST BE AUTHORIZED BY THE ENGINEER.
4. THE CONTRACTOR IS RESPONSIBLE FOR OBTAINING LAND RIGHTS AND LOCAL, STATE, AND FEDERAL PERMITS OR OTHER PERMISSION NECESSARY TO PERFORM AND MAINTAIN THE PRACTICE.

Estimated Quantities

No.	ITEM	Quantity	UNIT
1	Mobilization	1	LS
2	Regrade Driveway	1	LS
3	Mn Dot Class V For Roadway	44.1	CY
4	Form Ditch Bottom	34.0	CY
5	Rip rap, MN dot Class I-II	22.2	CY
6	Geotextile, mn dot type IV	66.7	SY
7	18" Diameter CMP Culvert	46.0	LF
8	Seeding, mn dot 350	0.1	AC
9	Excavate Culvert Basins	51.0	CY
10	Topsoil Borrow	20.9	CY
11	Erosion Control Blanket, biodegradable Cat. 2	200.0	SY

PROJECT LOCATION

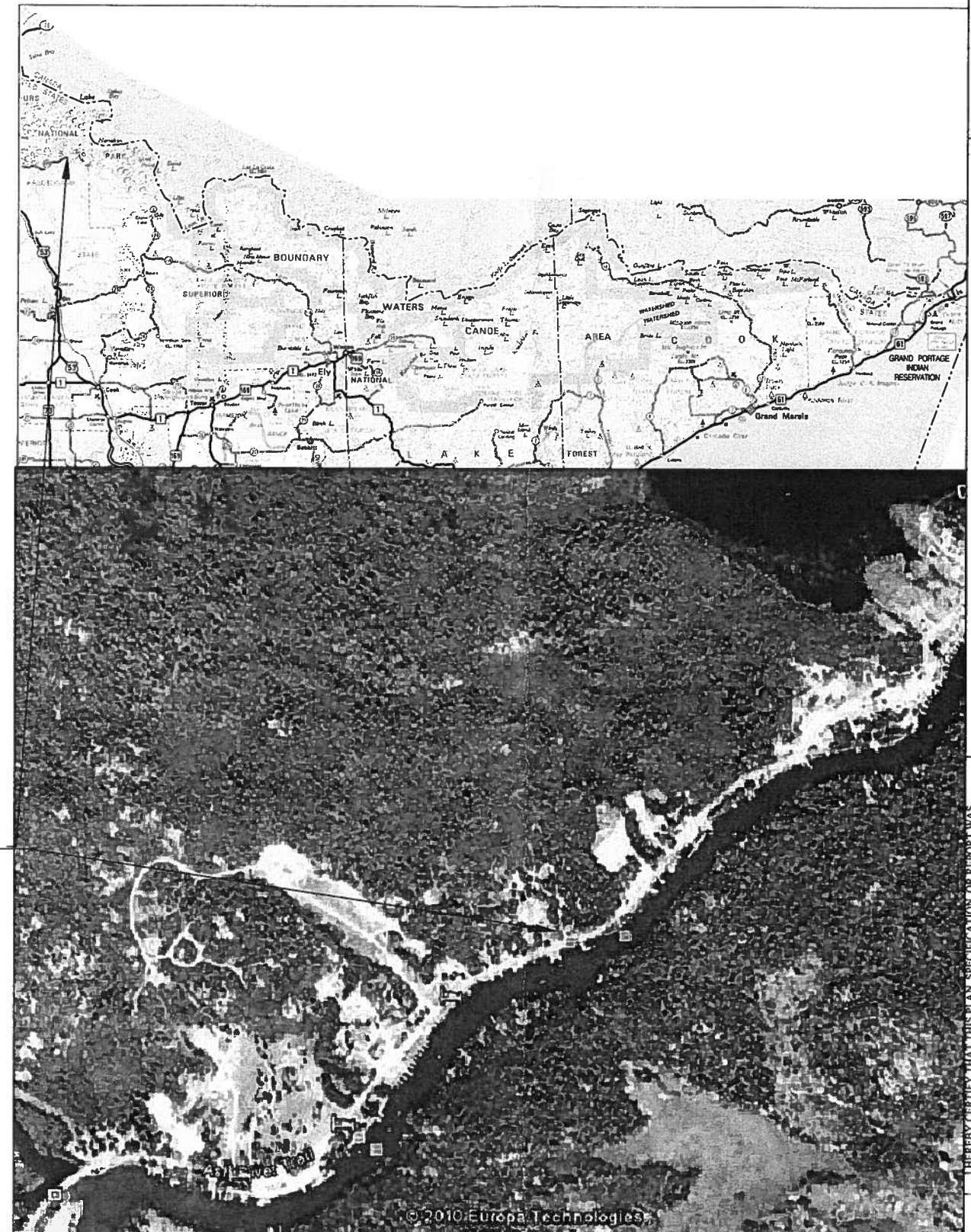

TITLE SHEET  
 SHEGA/ASH RIVER ROADWAY STABILIZATION  
 N. ST. LOUIS- SWCD  
 ST. LOUIS COUNTY, MINNESOTA

I HEREBY CERTIFY THAT THIS PLAN, SPECIFICATION, OR REPORT WAS PREPARED BY ME OR UNDER MY DIRECT SUPERVISION AND THAT I AM A DULY LICENSED PROFESSIONAL ENGINEER UNDER THE LAWS OF THE STATE OF MINNESOTA.  
 PRINTED NAME: KEITH ANDERSON  
 SIGNATURE: [Signature]  
 DATE: 1/4/11  
 REG. NO. 42827

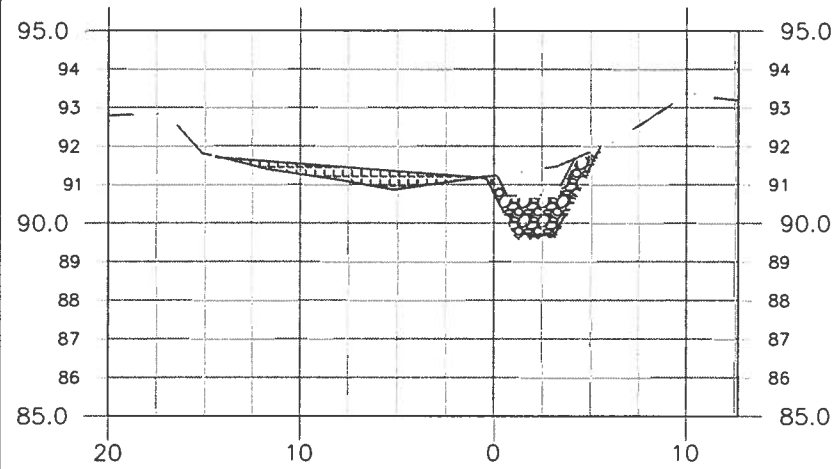

STA. 0+64 ALONG ditch

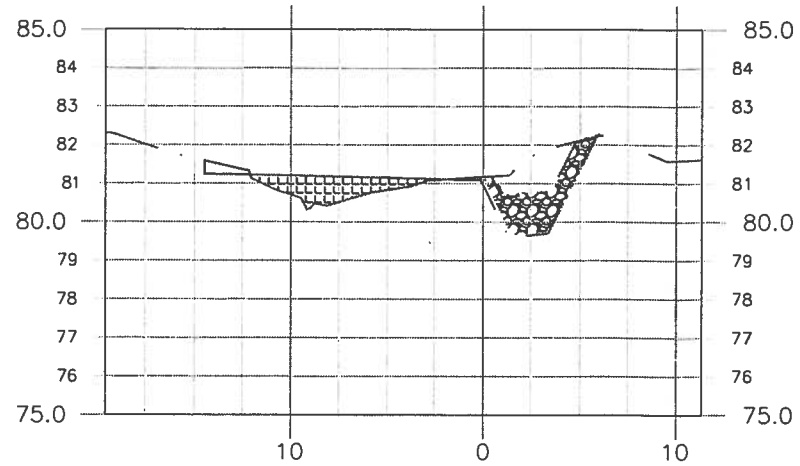

STA. 1+31 ALONG ditch

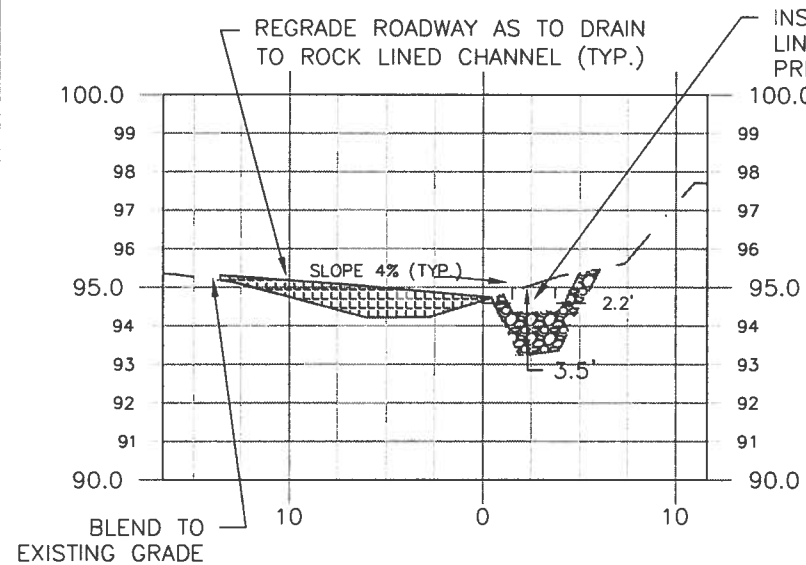
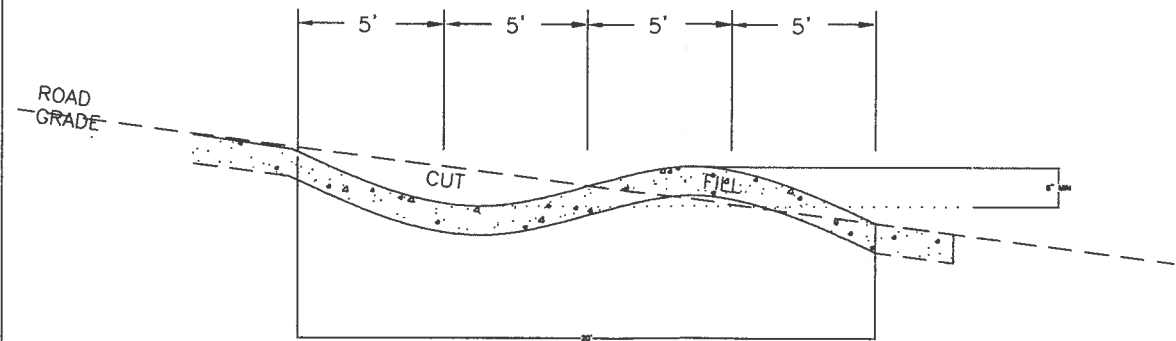

STA. 0+40 ALONG ditch

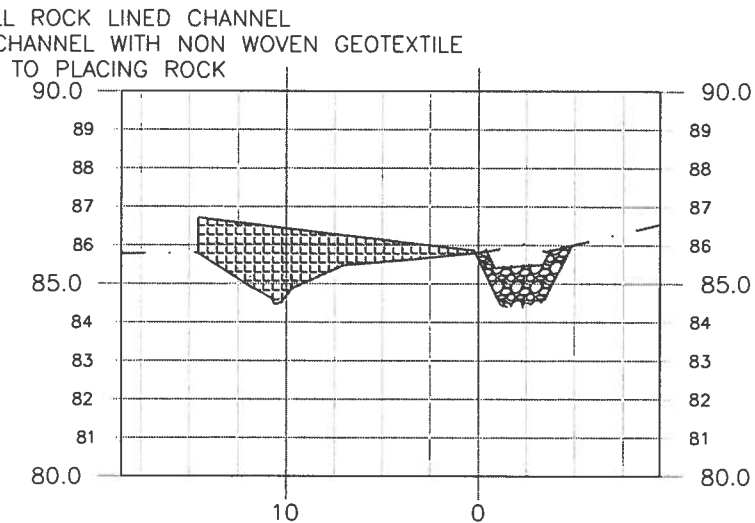

STA. 1+00 ALONG ditch

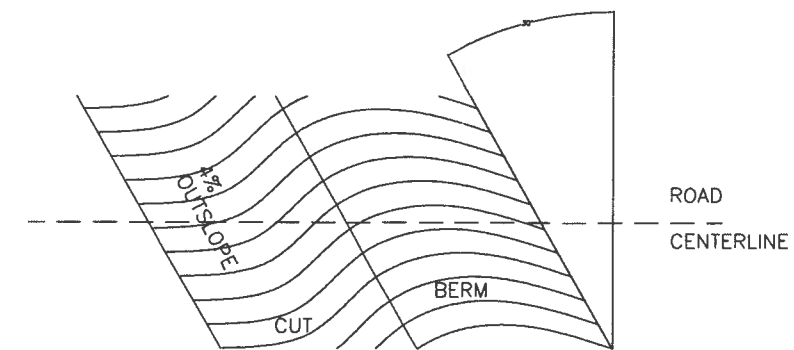

SWALE DETAIL

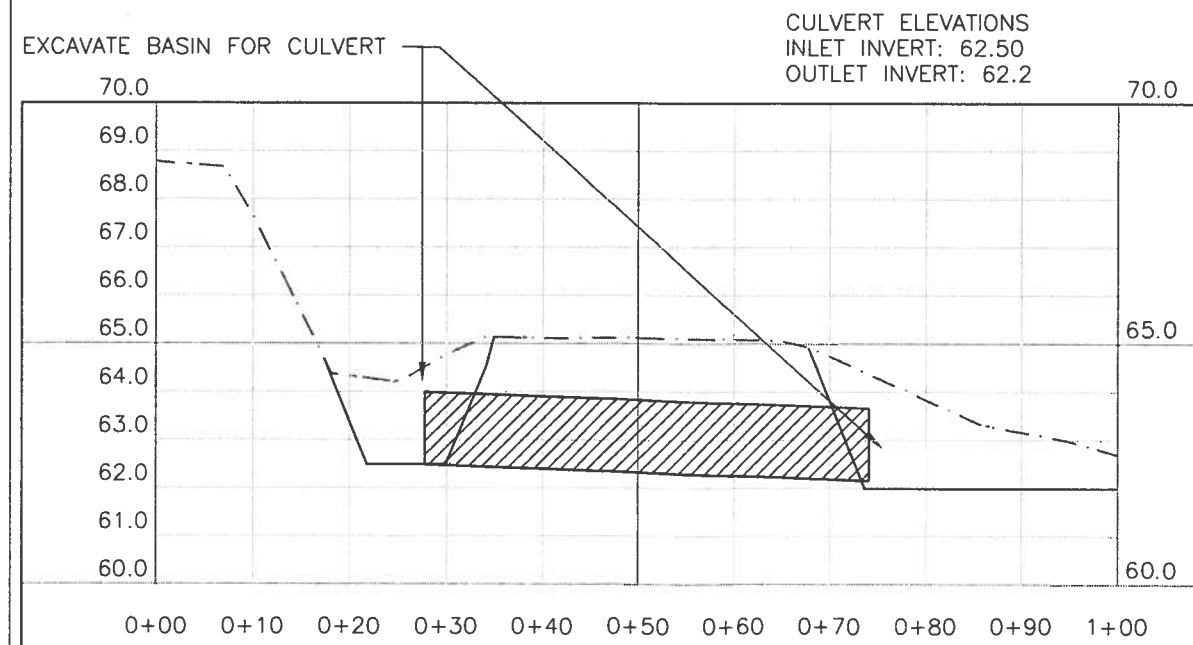

PROFILE ALONG culvert

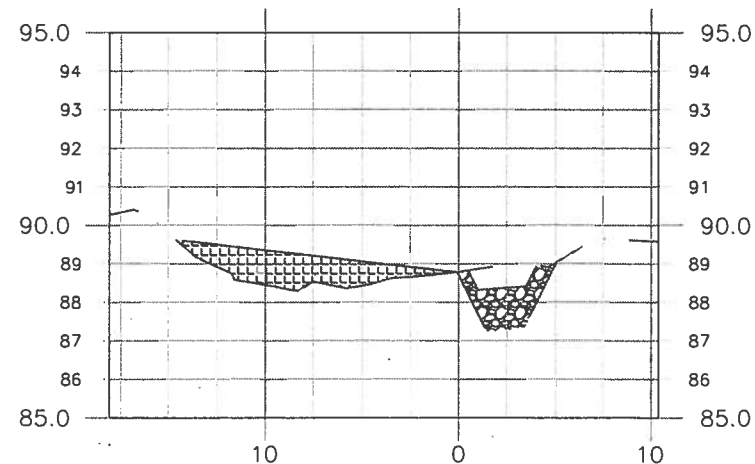

STA. 0+80 ALONG ditch



Date 12/10  
 Designed KAA  
 Drawn KAA  
 Revised  
 Checked

CROSS SECTIONS AND PROFILE  
 SHEGA/ASH RIVER ROADWAY STABILIZATION  
 N. ST. LOUIS - SWCD  
 ST. LOUIS COUNTY, MINNESOTA

I HEREBY CERTIFY THAT THIS PLAN, SPECIFICATION, OR REPORT WAS PREPARED BY ME OR UNDER MY DIRECT SUPERVISION AND THAT I AM A DULY LICENSED PROFESSIONAL ENGINEER UNDER THE LAWS OF THE STATE OF MINNESOTA.  
 PRINTED NAME: KEITH A. ANDERSON  
 SIGNATURE: [Signature]  
 DATE: 1/28/11  
 REG. NO. 42827